

HPM1900 Strain Gauge High Pressure Transmitter



Nanjing Hangjia Electronic Technology Co., LTD.

Overview

HPM1900 Strain Gauge High Pressure Transmitter adopts high-accuracy foil strain gauge as sensitive element with unique integrative elastic structure, excellent stability and reliability. The signal-processing circuit within stainless steel shell is processed through ageing testing, also with great linear calibration. This product is mainly used in the occasions of high pressure, ultra high pressure and high pressure impact.

Application: high pressure, ultra high pressure and high pressure impact

Features

- .Measuring diaphragm and pressure interface integrated structure
- .Hickey adopts 7 degree cone sealing surface
- .Vibration resistance, instantaneous pressure impact resistance
- .Maximal measuring pressure 600MPa
- .Germany imported plug, IP65 seals standards

Technical Parameters

Measuring Medium: liquid or gas compatible with 17-4PH stainless steel

Pressure Range: 0~40...600MPa

Overload: 1.5 times pressure range of full scale

Pressure Type: Gauge pressure

Accuracy: $\pm 0.5\%FS$

Long-term Stability: $\pm 0.2\%FS/year$

Temperature Coefficient of Zero: $\pm 0.03\%FS/^\circ C$ (Reference $25^\circ C$)

Temperature Coefficient of Full Scale: $\pm 0.03\%FS/^\circ C$ (Reference $25^\circ C$)

Operation Temperature: $-10\sim 85^\circ C$

Storage Temperature: $-40\sim 120^\circ C$

- Supply Voltage: 24VDC(10~30V)
- Output Signal: two-wire 4~20mADC
- Load Resistance: $\leq (U-10) / 0.02\Omega$
- Insulation Resistance: 100MΩ, 500VDC
- Ingress Protection of Shell: IP65
- Electrical Connection: DIN43650, aviation connector or cable outlet

Structure Drawings

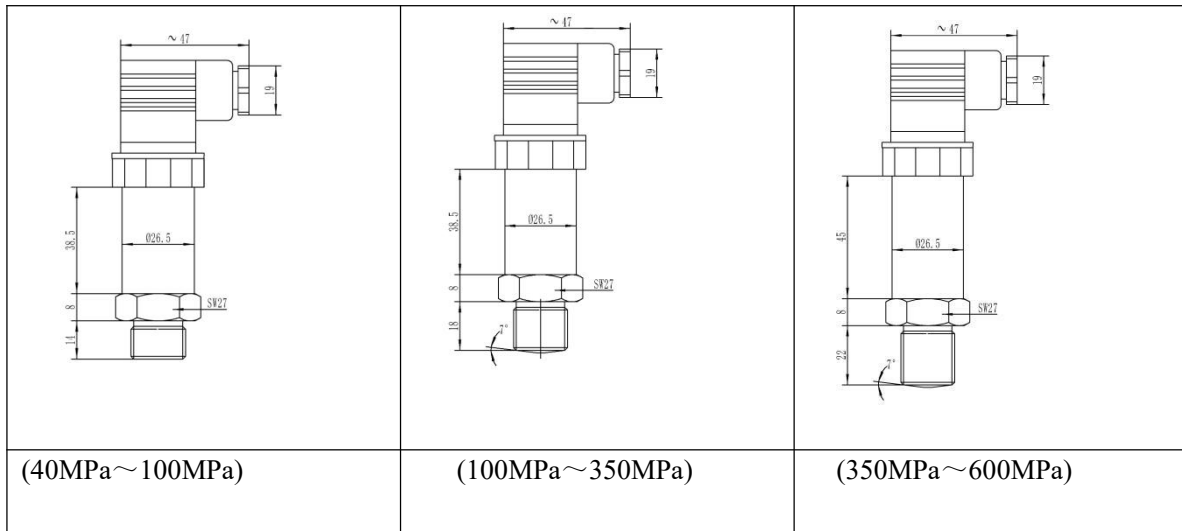

Electrical Connection

Hirschmann connector wiring method:

Pin	Wire	Two Wire
1	Red	Power (+V)
2	Black	Power (0V/+OUT)

Hirschmann connector dimensions

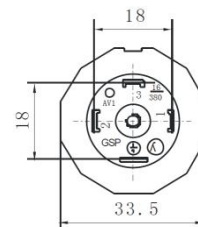

Two Wire:

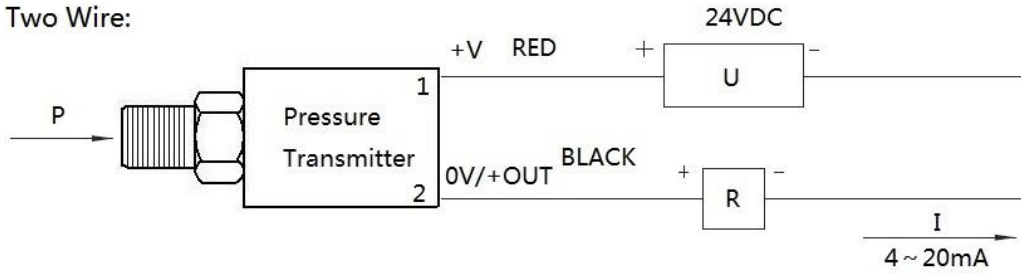

Ordering Guide

Item NO.	Type						
HPM1900	Strain Gauge High Pressure Transmitter						
	Pressure Range	Measuring Range					
	(0 ~ X)MPa	Fill out X directly					
		Code	Output Signal				
		B1	(4 ~ 20)mA				
		B4	(0 ~ 5)V				
		Code	Thread Spec				
			P1	M20×1.5			
			P3	G1/4			
		Code	Electrical Connection				
				C1	DIN43650		
				C2	Cable Output		
		Code	Structure&Material				
MH				17-4PH			
Code				Code			
		Special Requirements					
HPM1900	(0~100)MPa	B1	P1	C1	MH		